

**DATE:** 9 August 2025  
**DESIGNER:** Alex Naper  
**PROJECT No:** SES 11125  
**PROJECT NAME:** Old Slane Road Phase 3 - Lagan



MF derived from:  $0.92 \times 0.93$  or  $0.90 \times 0.99$  (LMF (Low pollution environment & 72 month cleaning cycle) x LLMF x LSF)  
LLMF & LSF values @ 100,000 hours & 25 degrees C Ta.

Residential area designed in accordance with EN13201-2:2015  
Category P4.

Access roundabout designed in accordance with EN13201-2:2015  
Category C4.

## Outdoor Lighting Report

**PREPARED BY:** Sabre Electrical Services Ltd.  
Unit 11,  
Bellview Industrial Estate,  
Tolka Valley Road,  
Dublin 11  
D11 VN59  
Phone Number: 01 8110875  
Contact: Graham Sheehan  
eMail: [graham@sabrelighting.ie](mailto:graham@sabrelighting.ie)

## Layout Report

### General Data

Dimensions in Metres Angles in Degrees

### Calculation Grids

ID	Grid Name	X	Y	X' Length	Y' Length	X' Spacing	Y' Spacing
1	Grid 1	705791.51	776042.51	155.64	195.00	1.50	1.50
2	Grid 2	705867.05	776041.43	48.00	39.00	1.50	1.50

### Luminaires

#### **Luminaire A Data**



Supplier	C U Phosco
Type	E950-28-P6A-730-C0600-15W
Lamp(s)	730N
Lamp Flux (klm)	2.35
File Name	E950-28-P6A-730-C0600-15W.ies
Maintenance Factor	0.82
Imax70,80,90(cd/klm)	961.6, 241.7, 0.0
No. in Project	9

#### **Luminaire B Data**



Supplier	C U Phosco
Type	E950-28-F2A-730-C600-15W
Lamp(s)	730N
Lamp Flux (klm)	2.28
File Name	E950-28-F2A-730-C0600-15W.ies
Maintenance Factor	0.82
Imax70,80,90(cd/klm)	623.6, 113.9, 0.3
No. in Project	3

#### **Luminaire D Data**



Supplier	C U Phosco
Type	E950-28-R3A-730-C250-7W
Lamp(s)	730N
Lamp Flux (klm)	1.00
File Name	E950-28-R3A-730-C0250-7W.ies
Maintenance Factor	0.85
Imax70,80,90(cd/klm)	716.7, 30.5, 0.3
No. in Project	2

#### **Luminaire E Data**



Supplier	C U Phosco
Type	E951-64-F4-G-730-W6-0325-30W
Lamp(s)	730SS
Lamp Flux (klm)	4.55
File Name	E951-64-F4-G-730-W6-0325-30W.ies
Maintenance Factor	0.85
Imax70,80,90(cd/klm)	367.5, 67.3, 0.0
No. in Project	1

#### **Luminaire H Data**



Supplier	C U Phosco
Type	E951-64-R1-G-730-W6-0400-36W
Lamp(s)	730SS
Lamp Flux (klm)	5.81
File Name	E951-64-R1-G-730-W6-0400-36W.ies
Maintenance Factor	0.85
Imax70,80,90(cd/klm)	402.2, 18.6, 0.0
No. in Project	1

#### **Luminaire I Data**



Supplier	C U Phosco
Type	E951-64-F4-G-730-W6-0325-30W
Lamp(s)	730SS
Lamp Flux (klm)	4.55
File Name	E951-64-F4-G-730-W6-0325-30W.ies
Maintenance Factor	0.85
Imax70,80,90(cd/klm)	367.5, 67.3, 0.0
No. in Project	1

**Luminaires**



**Luminaire J Data**

Supplier	C U Phosco
Type	E950-28-F2A-730-C600-15W
Lamp(s)	730N
Lamp Flux (klm)	2.28
File Name	E950-28-F2A-730-C0600-15W.ies
Maintenance Factor	0.82
Imax70,80,90(cd/klm)	623.6, 113.9, 0.3
No. in Project	1



**Luminaire K Data**

Supplier	C U Phosco
Type	E950-28-P6A-730-C0600-15W
Lamp(s)	730N
Lamp Flux (klm)	2.35
File Name	E950-28-P6A-730-C0600-15W.ies
Maintenance Factor	0.83
Imax70,80,90(cd/klm)	961.6, 241.7, 0.0
No. in Project	1

**Layout**

ID	Type	X	Y	Height	Angle	Tilt	Cant	Out-reach	Target X	Target Y	Target Z
1	H	705914.77	776078.10	8.00	271.00	0.00	0.00	0.50			
2	I	705879.01	776072.27	8.00	316.00	0.00	0.00	0.50			
3	A	705880.08	776094.54	6.00	356.00	0.00	0.00	0.40			
4	E	705891.34	776060.99	8.00	99.00	0.00	0.00	0.50			
5	B	705870.59	776119.30	5.00	23.00	0.00	0.00	0.40			
6	A	705868.70	776104.47	6.00	272.00	0.00	0.00	0.40			
7	B	705861.11	776140.03	5.00	23.00	0.00	0.00	0.40			
8	A	705869.14	776166.42	6.00	305.00	0.00	0.00	0.40			
9	A	705892.62	776173.65	6.00	152.00	0.00	0.00	0.40			
5m 10	A	705895.48	776102.78	5.00	181.00	0.00	0.00	0.40			
11	D	705913.37	776104.45	5.00	263.00	0.00	0.00	0.40			
12	A	705897.08	776124.05	6.00	98.00	0.00	0.00	0.40			
13	B	705915.11	776121.65	6.00	85.00	0.00	0.00	0.40			
14	A	705936.37	776176.48	6.00	263.00	0.00	0.00	0.40			
15	J	705950.44	776173.55	6.00	169.00	0.00	0.00	0.40			
16	A	705910.54	776172.16	6.00	83.00	0.00	0.00	0.40			
17	K	705889.07	776218.68	6.00	355.00	0.00	0.00	0.40			
18	A	705885.88	776196.40	6.00	0.00	0.00	0.00	0.40			
19	D	705871.78	776204.23	5.00	261.00	0.00	0.00	0.40			

# Horizontal Illuminance (lux)

Grid 1

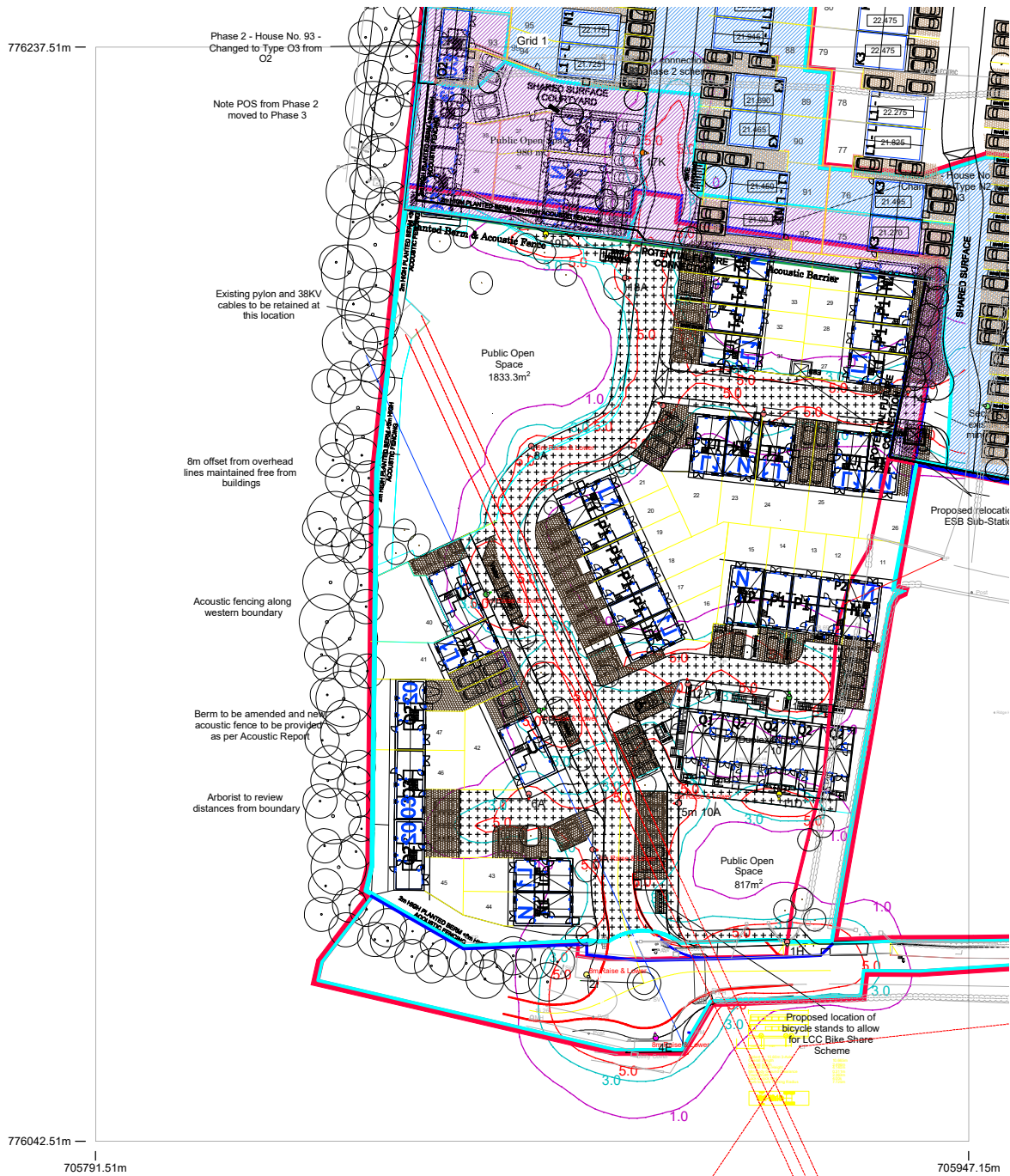

## Results

Eav	5.78
Emin	1.25
E <sub>max</sub>	17.67
E <sub>min</sub> /E <sub>max</sub>	0.07
E <sub>min</sub> /E <sub>av</sub>	0.22

## Horizontal Illuminance (lux)

Grid 2

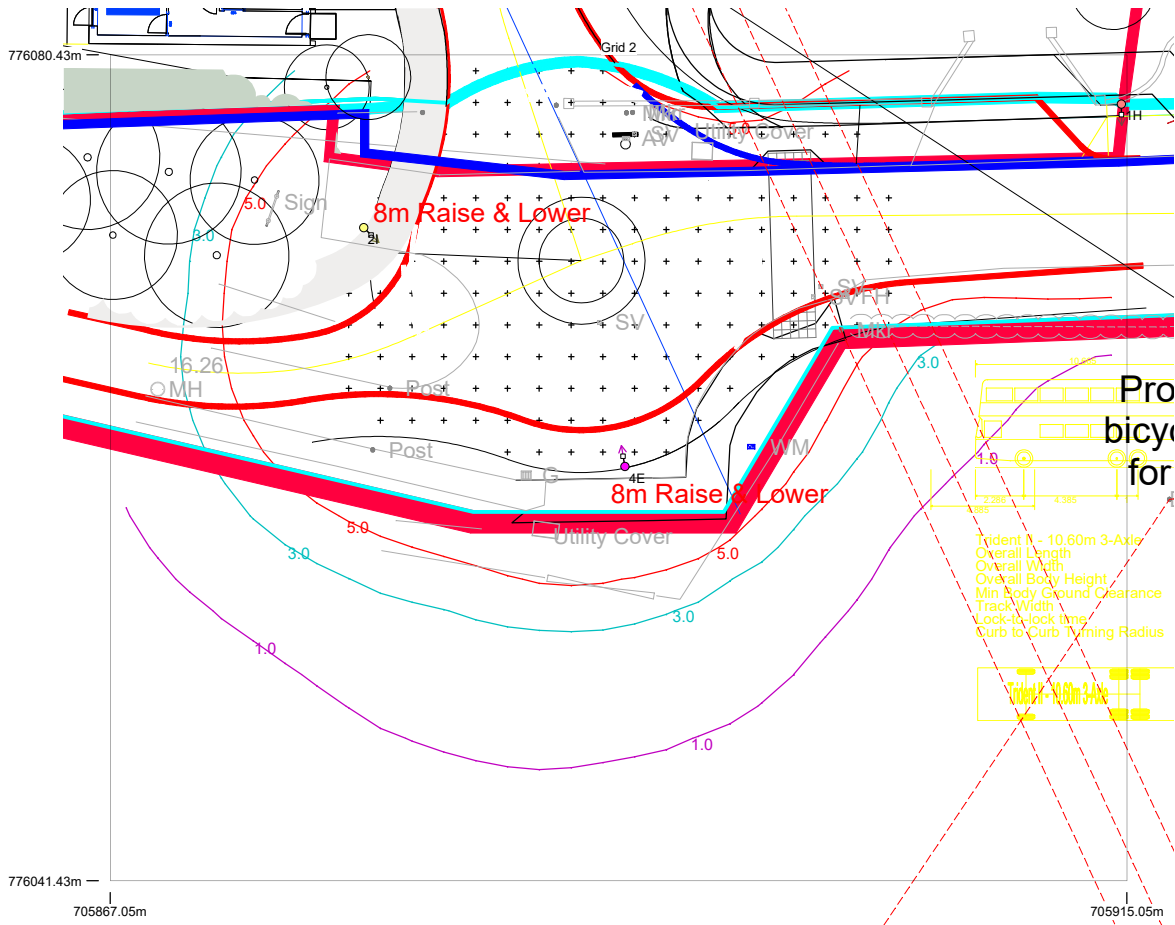

### Results

Eav	10.58
Emin	5.04
Emax	15.12
Emin/Emax	0.33
Emin/Eav	0.48